

Section 1. PRODUCT DESCRIPTION

CARRIAGE BOLT – SZM

SZM metric carriage bolt, for structural fastenings of sheet overlaps, members in steel and wooden structures. The bolt is made of zinc-plated low carbon steel. Metric thread over a part of length of the pin.

Bolt class: C
Tolerance of thread: 8g
Property class: 4.6
Yield point (f_{yb}): 240 MPa
Tensile strength (f_{ub}): 400 MPa



Metric bolts conform to: DIN 603

Section 2. TECHNICAL DATA

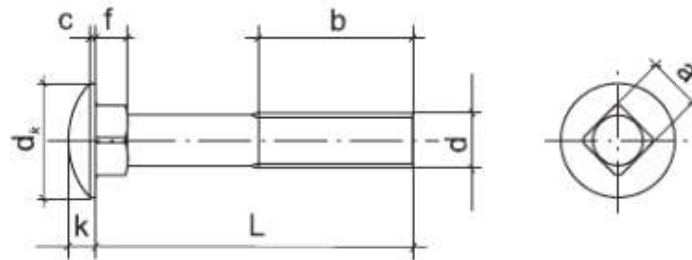

TABLE 1. TECHNICAL PARAMETERS / SELECTION TABLE

Thread	Product code	Diameter and length [d x L]	Scale	Thread length*	Head diameter	Head height	Head thickness	Planting height	Embed width	Pieces per pack
		[mm]								[mm]
M6	SZM-06020	6 x 20	1,00	18/24/37	14	3	0,6	4	6	3/10
	SZM-06025	6 x 25								3/10
	SZM-06030	6 x 30								3/10
	SZM-06035	6 x 35								3/10
	SZM-06040	6 x 40								3/10
	SZM-06045	6 x 45								3/10
	SZM-06050	6 x 50								3/10
	SZM-06055	6 x 55								3/10
	SZM-06060	6 x 60								3/10
	SZM-06065	6 x 65								3/10
	SZM-06070	6 x 70								3/10
	SZM-06080	6 x 80								3/10
	SZM-06090	6 x 90								3/10
	SZM-06100	6 x 100								3/10
M8	SZM-08025	8 x 25	1,25	22/28/41	18	4	0,8	5	8	3/10
	SZM-08030	8 x 30								3/10
	SZM-08035	8 x 35								3/10

	SZM-08040	8 x 40								3/10
	SZM-08045	8 x 45								3/10
	SZM-08050	8 x 50								3/10
	SZM-08055	8 x 55								3/10
	SZM-08060	8 x 60								3/10
	SZM-08070	8 x 70								3/10
	SZM-08080	8 x 80								3/10
	SZM-08090	8 x 90								3/10
	SZM-08100	8 x 100								3/10
	SZM-08110	8 x 110								3/10
	SZM-08120	8 x 120								3/10
	SZM-08130	8 x 130								3/10
	SZM-08140	8 x 140								3/10
	SZM-08150	8 x 150								3/10
M10	SZM-10060	10 x 60	1,50	26/32/45	23	5	1,0	6	10	3/10
	SZM-10080	10 x 80								3/10
	SZM-10100	10 x 100								3/10
	SZM-10120	10 x 120								3/10
	SZM-10140	10 x 140								3/10
	SZM-10160	10 x 160								3/10
	SZM-10180	10 x 180								3/10
	SZM-10200	10 x 200								3/10
M12	SZM-12060	12 x 60	1,75	30/36/49	28	6	1,2	8	12	3/10
	SZM-12080	12 x 80								3/10
	SZM-12100	12 x 100								3/10
	SZM-12120	12 x 120								3/10
	SZM-12140	12 x 140								3/10
	SZM-12160	12 x 160								3/10
	SZM-12180	12 x 180								3/10
	SZM-12200	12 x 200								3/10

*The length of the thread depends on the length of the screw L < 125 mm / 125 mm < L < 200 mm / L > 200 mm

Section 3. REMARKS

1. All previous versions of this Product Data Sheet shall cease to be valid
2. Data given in this Product Data Sheet is in accordance with current knowledge and published in good faith. KLIMAS Sp. z o.o. is not responsible for correctness and quality of the fixing if recommendations regarding method of use and installation are not followed.