

EL[®]MARK

The Brand of Electricity

DIMMER SWITCH 0-10V



Technical characteristics

- ∴ Model: Series City 1-10V Dimmer switch
- ∴ Wiring: 1 Way
- ∴ Input: 250V 10A
- ∴ Output: 1-10V 40mA
- ∴ Rated Voltage: 1-10V DC
- ∴ Working Frequency: 50Hz
- ∴ Working Temperature: 0-40°C
- ∴ Dimmable LED light: 5-200VA
- ∴ Load type: capacitive

Description

Dimmer switch is a dimming wall switch designed for dimming drivers with a control voltage of 0-10V DC

[PRODUCT DETAILS »](#)

Catalogue number	Type	Input	Output	Barcode	Pack/box
190193	Dimmer switch	250V 10A	1-10V 40mA	3800131253392	1/60

[ASSEMBLY»](#)

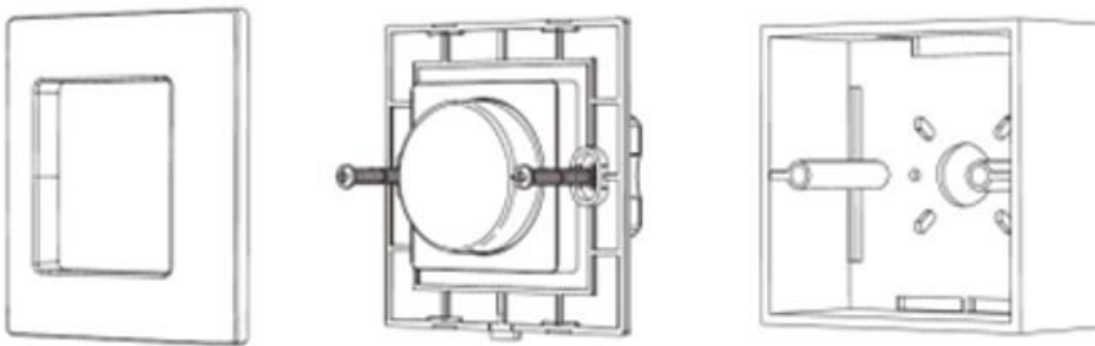

[WIRING SCHEME](#)

